

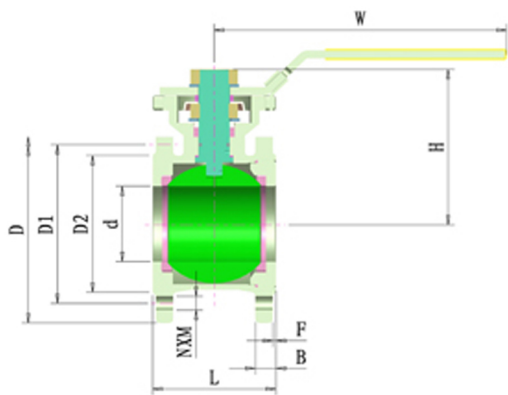

## Wafer Type Ball Valve

(1/2"~2": PN40, 2-1/2"~6":PN16)

(TEST&INSPECTION):      API598      JB/T9092  
 (FLANGE CONNECTION):    DIN2543      DIN2545

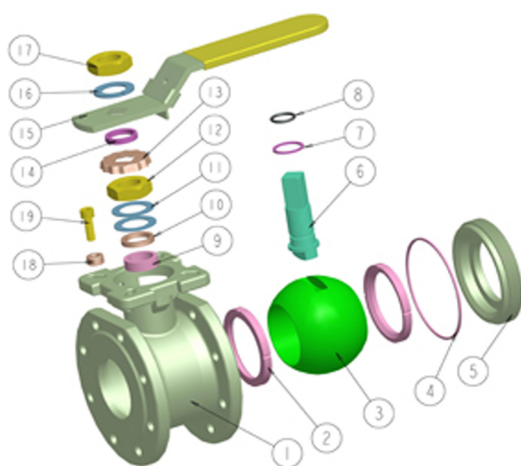

NO	PART NAME	MATERIAL	
1	BODY	CF8M	WCB
2	SEAT	PTFE	PTFE
3	BALL	SS316	SS304
4	JOINT GASKET	PTFE	PTFE
5	CAP	CF8M	WCB
6	STEM	SS316	SS304
7	THRUST WASHER	PTFE	PTFE
8	O-RING	VITON	VITON
9	PACKING	PTFE	PTFE
10	GLAND	SS304	SS304
11	BELLEVILLE WASHER	SS316	SS316
12	NUT	SS304	SS304
13	CROWN WASHER	SS304	SS304
14	WASHER	SS304	SS304
15	HANDLE	SS201	SS201
16	SPRING WASHER	SS304	SS304
17	NUT	SS304	SS304
18	WASHER	SS304	SS304
19	BOLT	SS304	SS304

(MAIN SIZE):

(UNIT): mm

SIZE	1/2"	3/4"	1"	1-1/4"	1-1/2"	2"	2-1/2"	3"	4"
d	15	20	25	32	38	50	63	77	96
L	40.8	44	50	60	65	80	110	120	150
D	95	105	115	140	150	165	185	200	220
D1	65	75	85	100	110	125	145	160	180
D2	45	58	68	78	88	102	122	138	158
B	16	18	18	18	18	20	18	20	20
F	2	2	2	2	3	3	3	3	3
NXM	4XM12	4XM12	4XM12	4XM16	4XM16	4XM16	4XM16	8XM16	8XM16
H	65	67.5	74.5	87	103	110.6	131.8	153.3	168.3
W	135	135	142	142	200	200	210	283	283

Note: The above technical data are just for your reference only any questions, please contact us.