

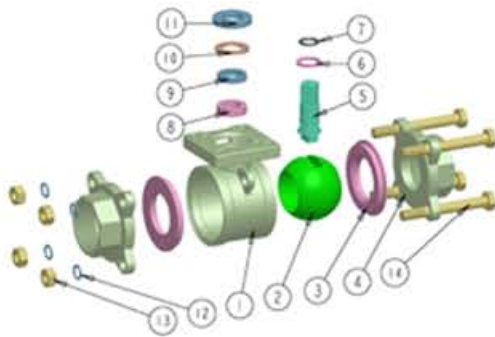

3 Pc. ISO 5211 Top Flange AISI 316 Screwed End Ball Valves 1000PSI

(DESIGN STANDARD): ASME B16.34 GB/T12237
 (TEST & INSPECTION): API 598 JB/T9092

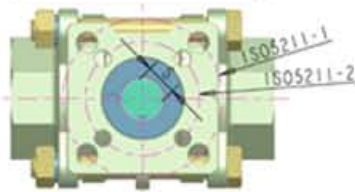
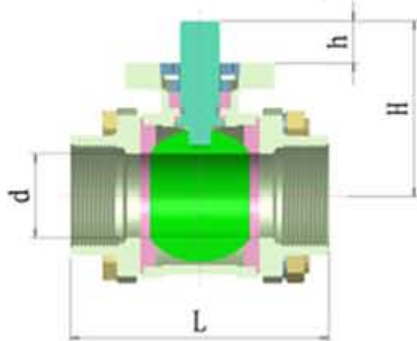

(MAIN PARTS MATERIALS):

NO	PART NAME	MATERIAL	
1	BODY	CF8M	WCB
2	BALL	SS316	SS304
3	SEAT	PTFE	PTFE
4	CAP	CF8M	WCB
5	STEM	SS316	SS304
6	THRUST WASHER	PTFE	PTFE
7	O-RING	VITON	VITON
8	PACKING	PTFE	PTFE
9	GLAND	SS304	SS304
10	WASHER	SS304	SS304
11	GLAND	SS304	SS304
12	SPRING WASHER	SS304	SS304
13	NUT	SS304	SS304
14	BOLT	SS304	SS304

(MAIN SIZE):

(UNIT): mm

SIZE	1/4"	3/8"	1/2"	3/4"	1"	1-1/4"	1-1/2"	2"	2-1/2"	3"	4"
d	11.6	12.7	15	20	25	32	40	50	65	80	100
L	67	67	73	82.5	88	111	120	143.8	173.6	203	241
H	40	40	40	44	52	58	64	77	98	110	132
h	7	7	7	9	12	12	16	16	16.5	16.5	24
S	9	9	9	9	11	11	14	14	17	17	22
ISO5211	F04 F03	F04 F03	F04 F03	F04 F03	F05 F04	F05 F04	F07 F05	F07 F05	F10 F07	F10 F07	F12

Note: The above technical data are just for your reference only any questions, please contact us.